

All rights strictly reserved. Reproduction or issue to third parties in any form whatever is not permitted without written authority from the proprietor. Property of Rosenberger Hochfrequenztechnik.

Montagebohrung
panel piercing
B 176
M 1:1

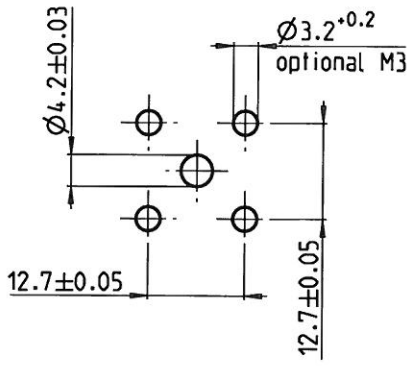

Die angegebenen Masse und Toleranzen sind nur Empfehlungen.
The stated dimensions are only recommendations.

Format: H, T, C, F, G, O, D, P, A, S, Montagebohrung
Datei: AS
13, 18, 20, 25, 30, 35, 40, 45, 50, 55, 60, 65, 70, 75, 80, 85, 90, 95, 100, 105, 110, 115, 120, 125, 130, 135, 140, 145, 150, 155, 160, 165, 170, 175, 180, 185, 190, 195, 200, 205, 210, 215, 220, 225, 230, 235, 240, 245, 250, 255, 260, 265, 270, 275, 280, 285, 290, 295, 300, 305, 310, 315, 320, 325, 330, 335, 340, 345, 350, 355, 360, 365, 370, 375, 380, 385, 390, 395, 400, 405, 410, 415, 420, 425, 430, 435, 440, 445, 450, 455, 460, 465, 470, 475, 480, 485, 490, 495, 500, 505, 510, 515, 520, 525, 530, 535, 540, 545, 550, 555, 560, 565, 570, 575, 580, 585, 590, 595, 600, 605, 610, 615, 620, 625, 630, 635, 640, 645, 650, 655, 660, 665, 670, 675, 680, 685, 690, 695, 700, 705, 710, 715, 720, 725, 730, 735, 740, 745, 750, 755, 760, 765, 770, 775, 780, 785, 790, 795, 800, 805, 810, 815, 820, 825, 830, 835, 840, 845, 850, 855, 860, 865, 870, 875, 880, 885, 890, 895, 900, 905, 910, 915, 920, 925, 930, 935, 940, 945, 950, 955, 960, 965, 970, 975, 980, 985, 990, 995, 1000

METRIC -



ISO-Projektion
Methode E

Rosenberger
Hochfrequenztechnik
84526 Tittmoning Pro/ENGINEER

title:
Montagebohrung
panel piercing

				date	name	part-no.:
				drawn 06.10.2003	A_Nobis	MB_176
				check. 22.04.04	Kna.J.	sheet/of: 1/1
				appr.		general tolerance
						ISO 2768
b00	04-0289	A_Nobis	22.04.2004	distribu-	FE AZ QSM RMT .	m-H
a00	03-0662	A_Nobis	06.10.2003	tion to:	
rev.	change-no	name	date	remarks:		