

Cable Clamp

SLCC2X1-ZF1

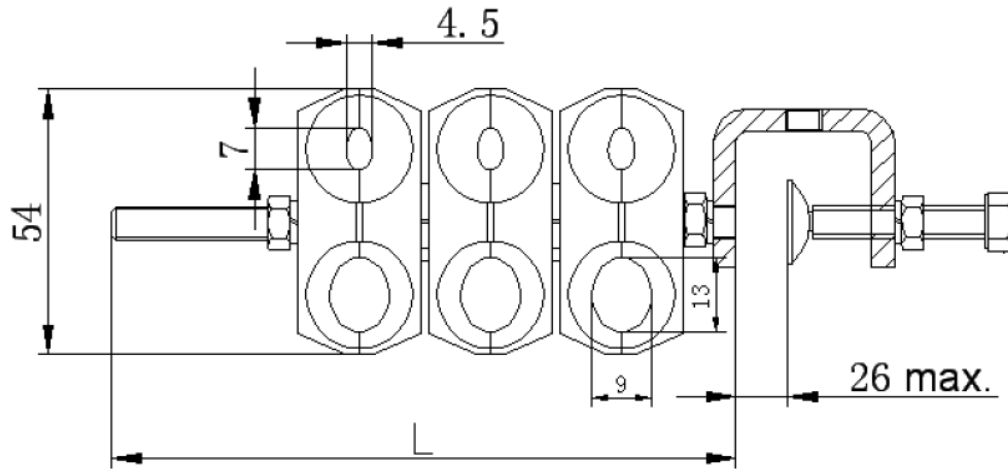

Part number	L	Picture
SLCC221-ZF1	70	
SLCC241-ZF1	90	
SLCC261-ZF1	130	

All dimensions are in mm, tolerances acc. To ISO 2768 c-H

Description

To install multiple cable runs on towers where space is limited. Without additional adapters, these clamps can provide sturdy, reliable, long-term support by means of tough and UV resistant material.

Part number

SLCC2X1-ZF1

Cable Clamp for: cables with $\varnothing 4.5 - 6.5\text{mm}$ (grey)
cables with $\varnothing 9 - 13\text{mm}$ (black)

X: number of cables

Cable Clamp

SLCC2X1-ZF1

Parts list

Number	Piece parts	Material
1	Threaded rod M8xL	Stainless steel SUS304
2	Nut M8	Stainless steel SUS304
3	Plain washer	Stainless steel SUS304
4	Plastic cable clamp	Polypropylene
5	Insert	Rubber
6	Spring washer	Stainless steel SUS304
7	Bowl washer	Stainless steel SUS304
8	C-Frame	Stainless steel SUS304
9	Bolt M8x45	Stainless steel SUS304

Environmental data

Temperature	-40°C to +70°C
Salt spray test	96 hr. acc. to MIL-STD-1344:1977 Method 1001.1
UV resistance	300 hr. acc. to ISO 4892-2:2006(E) Method A
RoHS	compliant

Tooling

Hex Wrench	13mm
------------	------

Packaging

Standard	10 pcs in bag
----------	---------------

Part number	Weight / pce
SLCC221-ZF1	160 g
SLCC241-ZF1	210 g
SLCC261-ZF1	260 g

While the information has been carefully compiled to the best of our knowledge, nothing is intended as representation or warranty on our part and no statement herein shall be construed as recommendation to infringe existing patents. In the effort to improve our products, we reserve the right to make changes judged to be necessary.

Draft	Date	Approved	Date	Rev.	Engineering change number	Name	Date
Robin	08/09/2010	E. Truc-Vallet	05.10.15	b00	15-1343	S. Huber-Siegl	05.10.15